

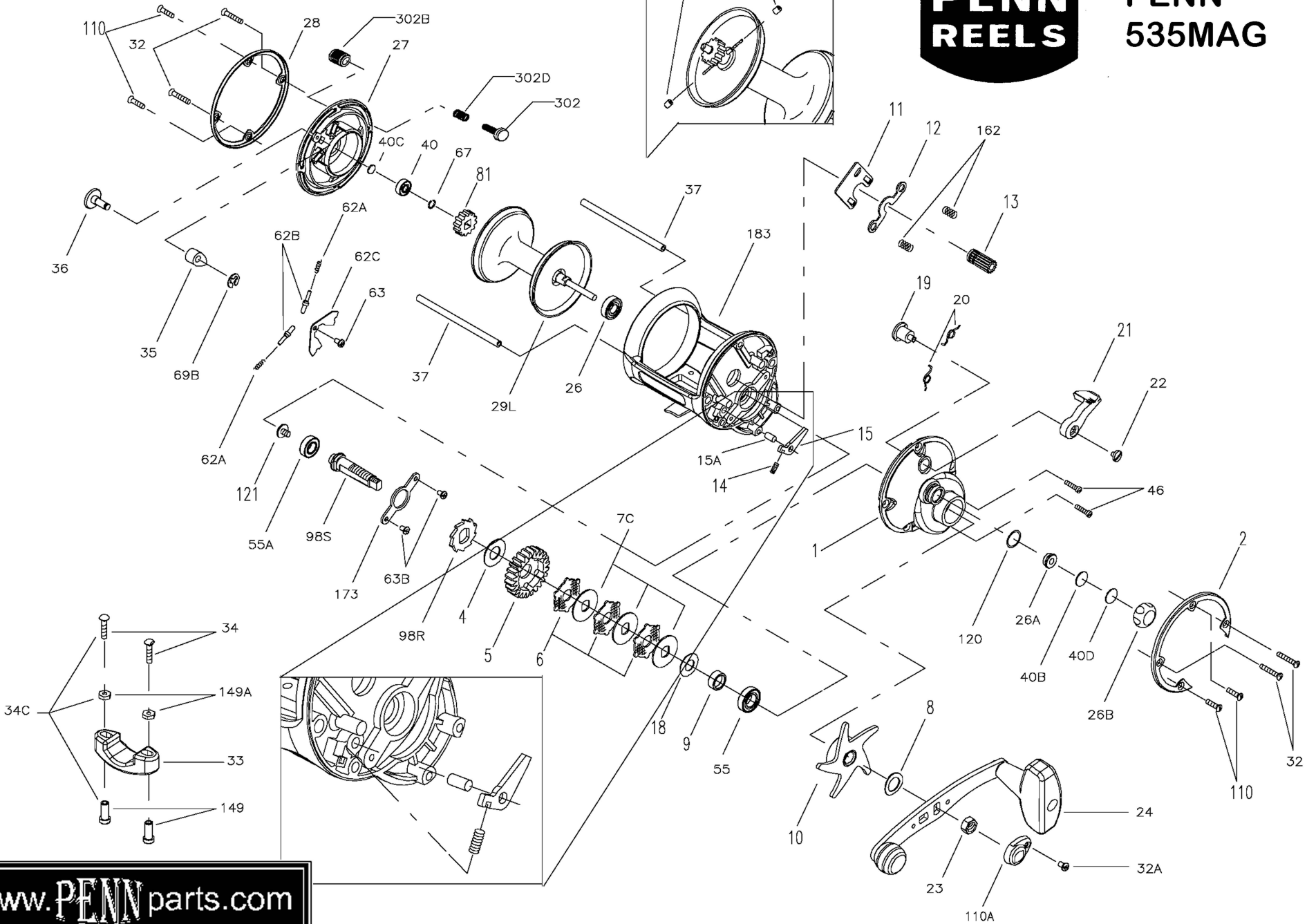

PENN  
535MAG

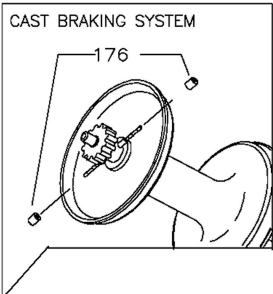

## Penn Reel Parts list for:

Model: 535MAG

KEY PART			KEY PART		
NO	NO.	DESCRIPTION	NO	NO.	DESCRIPTION
1	1-535	RIGHT SIDE PLATE	34C	34C-45	ROD CLAMP SCREW W/ NUTS
2	2-535	RIGHT SIDE PLATE	35	35-310N	CLICK TONGUE
4	4-60	FIBER WASHER	36	36-555	CLICK BUTTON
5	5-545MAG	MAIN GEAR	37	37-535	FRAME POST (2 REQ.)
6	6-49MAG	FRICTION DRAG WASHER (3 REQ.)	40	40-320	L.S. SPOOL BALL BEARING
7C	86-49L	METAL DRAG WASHER (3 REQ.)	40B	40C-555	METAL THRUST WASHER
8	8-60	TENSION SPRING WASHER	40C	40C-310	METAL THRUST WASHER
9	9-555	SPACING SLEEVE	40D	40D-555	RUBBER THRUST WASHER
10	10N-555	DRAG STAR	46	46-4300	SIDE PLATE SCREW (2 REQ.)
11	11-535	ECCENTRIC JACK	55	55-12H	BALL BEARING
12	12-555	PINION YOKE	55A	20-722	BALL BEARING
13	13-545	PINION GEAR	62A	62-545	CLICK SPRING (2 REQ.)
14	14-535	DOG SPRING	62B	62B-310	CLICK PIN (2 REQ.)
15	15-535	DOG	62C	62C-310	CLICK SPRING COVER
15A	158-535	DOG PIN	63	63-500S	CLICK SPRING SCREW
18	18-505	TENSION SPRING WASHER	63B	63-330	BEARING RETAINER SCREW (2 REQ.)
19	19-535	ECCENTRIC	67	67-9	LOCK RING
20	20-155	ECCENTRIC SPRING (2 REQ.)	69B	69B-600	RETAINING RING
21	21-310	ECCENTRIC LEVER	81	81-555	CLICK RATCHET
22	22-310	ECCENTRIC SCREW	98R	98-555	MAIN GEAR RATCHET
23	23-555	HANDLE NUT	98S	134-555	GEAR STUD
24	24-525	HANDLE	110	110-50	SIDE PLATE SHORT SCREW (4 REQ.)
26	26-25	R.S. SCREW BALL BEARING	110A	110A-555	HANDLE NUT LOCK CAP
26A	26-555	RIGHT SIDE BUSHING	120	120-113H	O-RING
26B	26B-555	SPOOL TENSION CONTROL CAP	121	121-525	BEARING SCREW
27	27-535MAG	LEFT SIDE PLATE	149	149-45	ROD CLAMP NUT (2 REQ.)
28	28-535	LEFT SIDE RING	149A	149-200	ROD CLAMP HEX NUT (2 REQ.)
29L	29L-535	ALUMINUM SPOOL ASSEMBLY	162	162-130	CLUTCH SPRING (2 REQ.)
32	32-310	FRAME POST SCREW (4 REQ.)	173	173-555	BEARING RETAINER
32A	32-15	HANDLE LOCK SCREW	176	176-555	CASTING BRAKES (2 REQ.)
33	33-113	ROD CLAMP	183	183-535	FRAME
34	34-45	ROD CLAMP SCREW (2 REQ.)	302	302-535MAG	MAGNET HOUSING
			302B	302B-525MAG	MAGNET KNOB

NOTE: Many of [www.pennparts.com](http://www.pennparts.com) schematics include changes that were either made by Penn, or errors found and corrected by our parts dept.

AS OF 9/12/04